

OSMA Infrastructure:
Rock Swales & Concrete “V” Ditches

- The following maps identify the length and type of drainage ditches in Fountaingrove II Open Space and any associated Drains
- The ditches identified as “CVD” are concrete “V” ditches. There is a total of 3,135 linear feet of CVD. The width varies from 2 feet to 4 feet.
- The ditches identified as RS are Rock Swales. There is a total of 6,055 linear feet of RS. On average they are about 30” wide, but vary from 18” to 6’
- In addition to the CVD’s and RS’s, the maps identify a 225’ sidewalk, a 55’ retaining wall and a small dam and settling pond that were not included in the last reserve study.

LOWER CROWN HILL

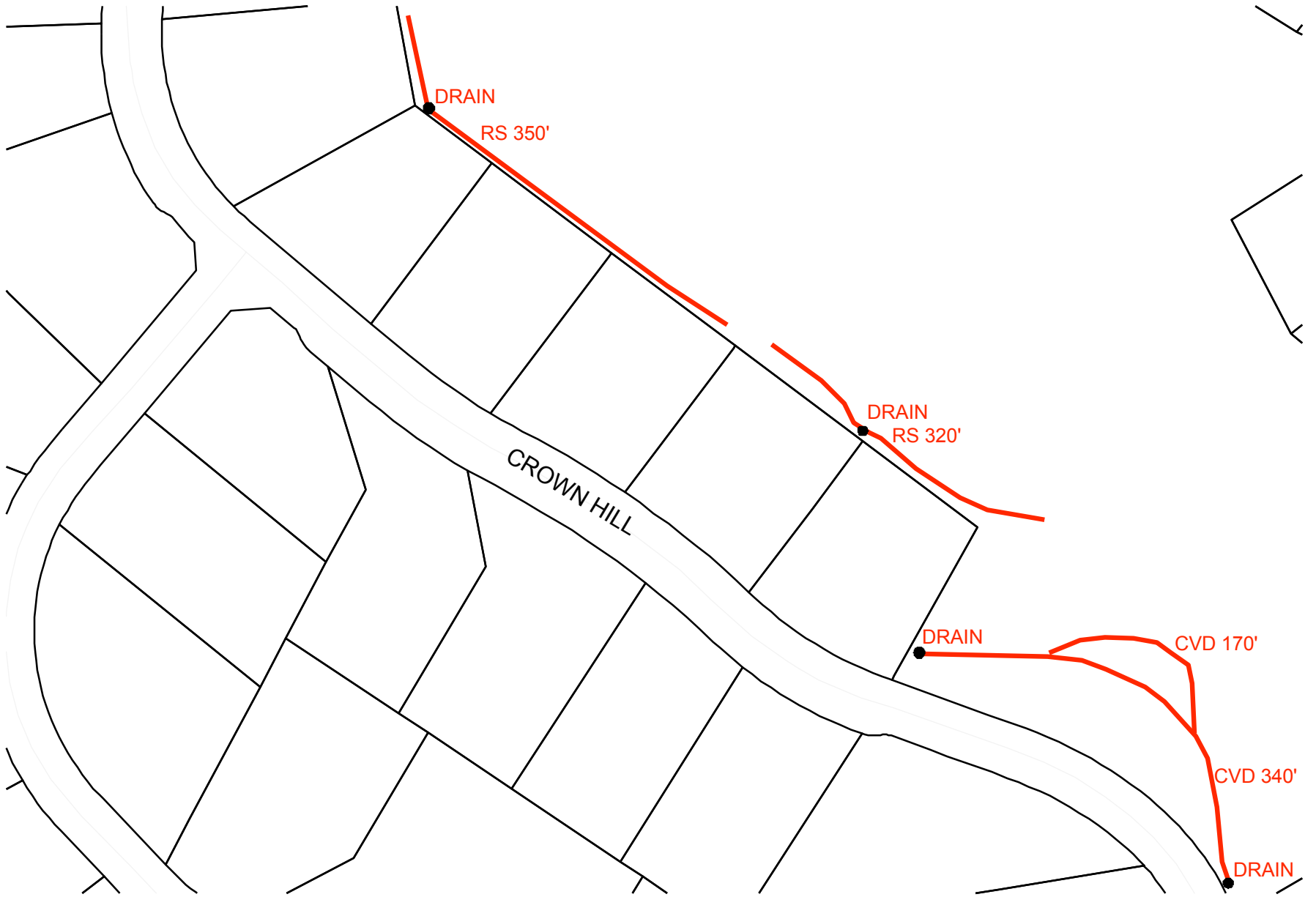

BELLAGIO, INCANTARE

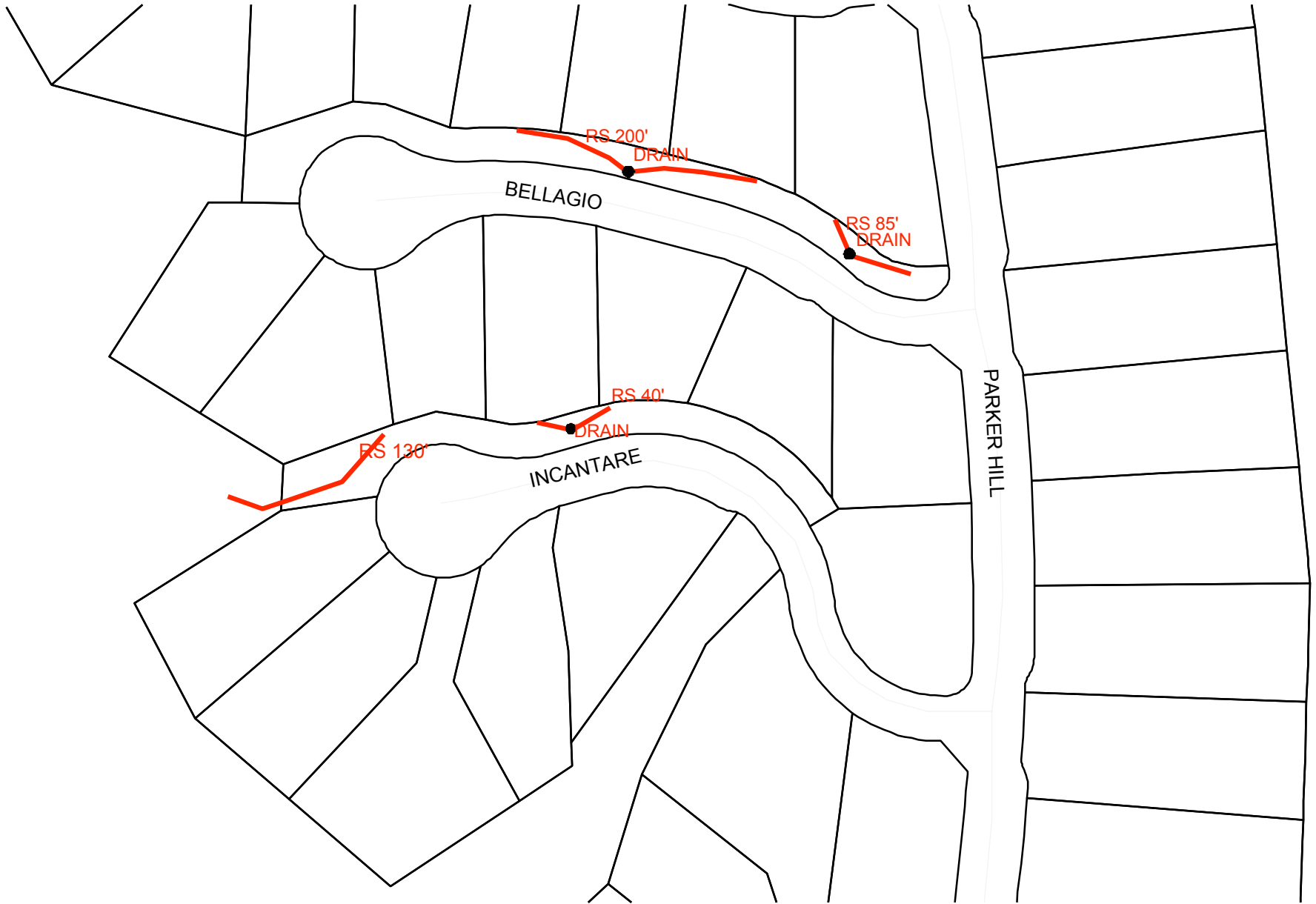

DARLINGTON, GIORNO, PALAZZO, LOWER PARKER HILL



EAST FOUNTAINGROVE PKY BELOW BOULDER POINT

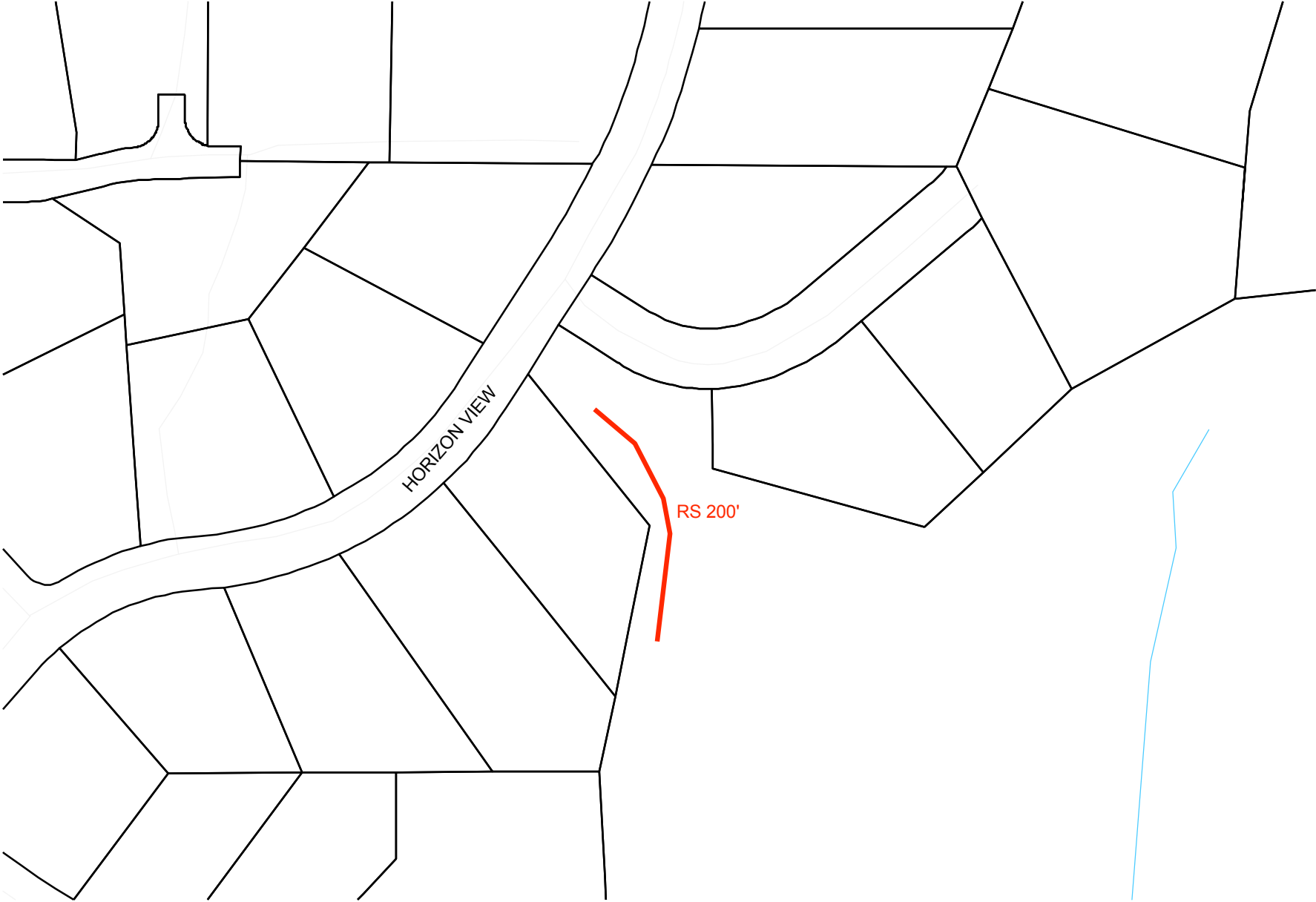

MIDDLE PARKER HILL

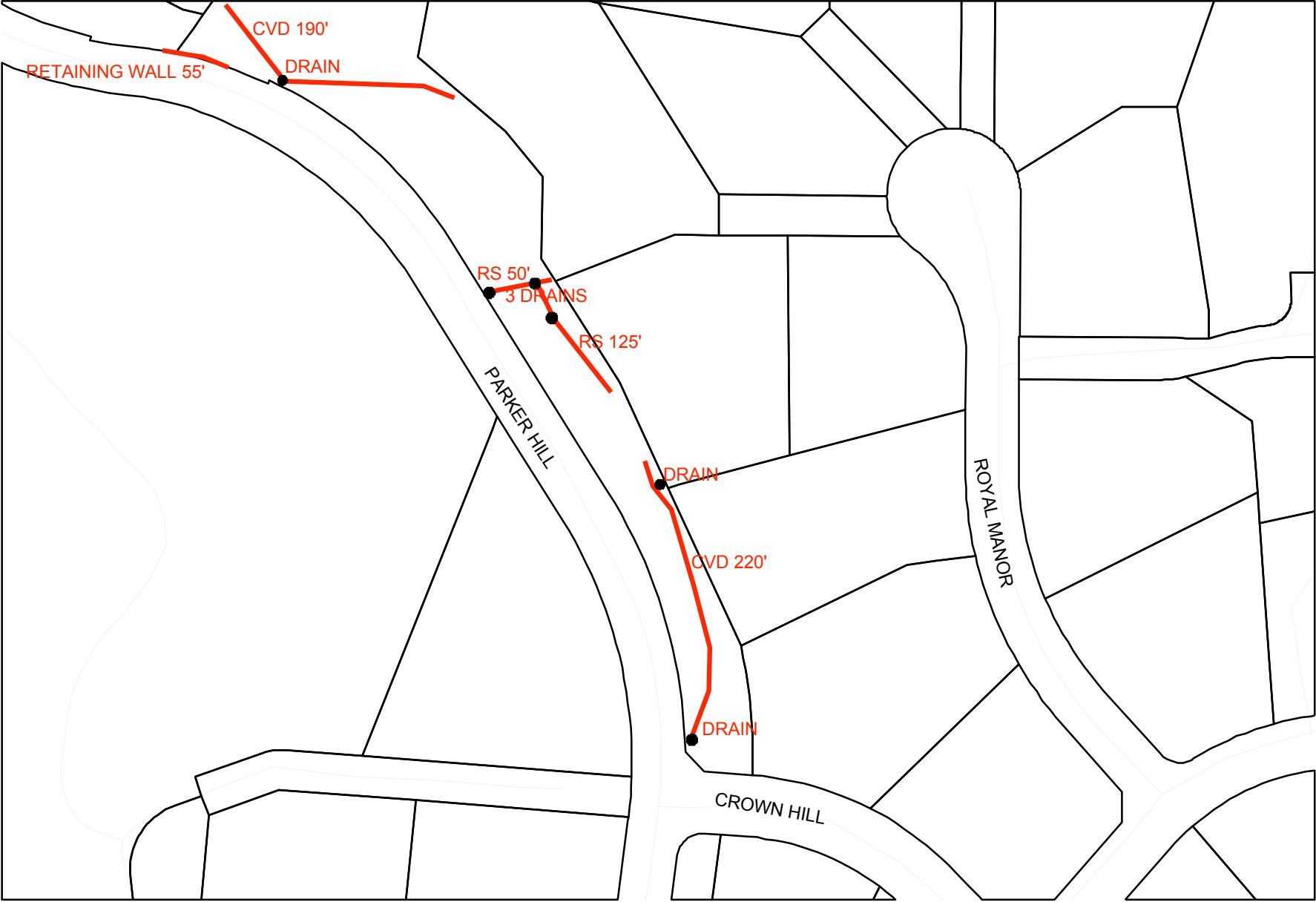

UPPER PARKER HILL

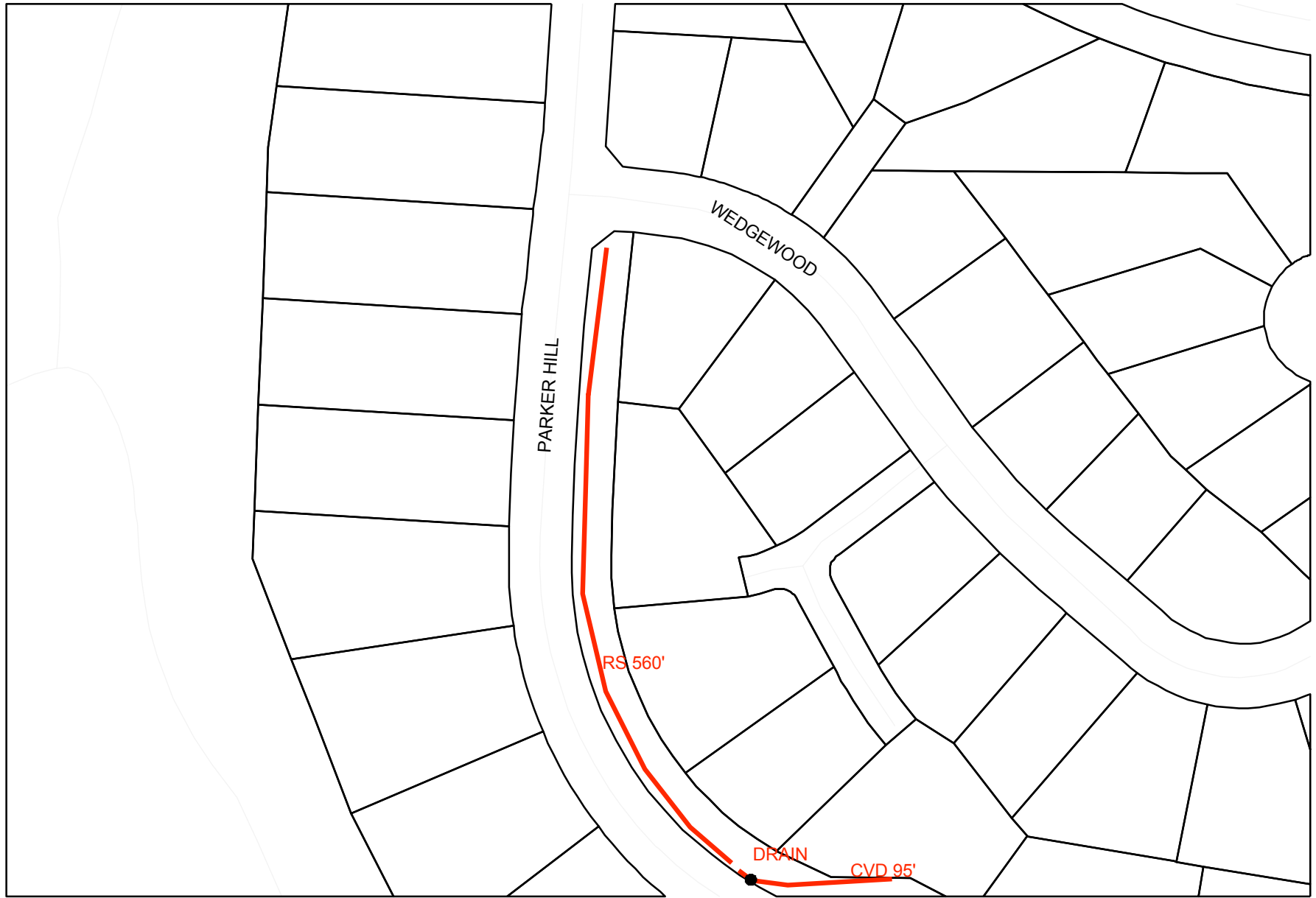

DAM AND POND BELOW FOUNTAINGROVE PKY

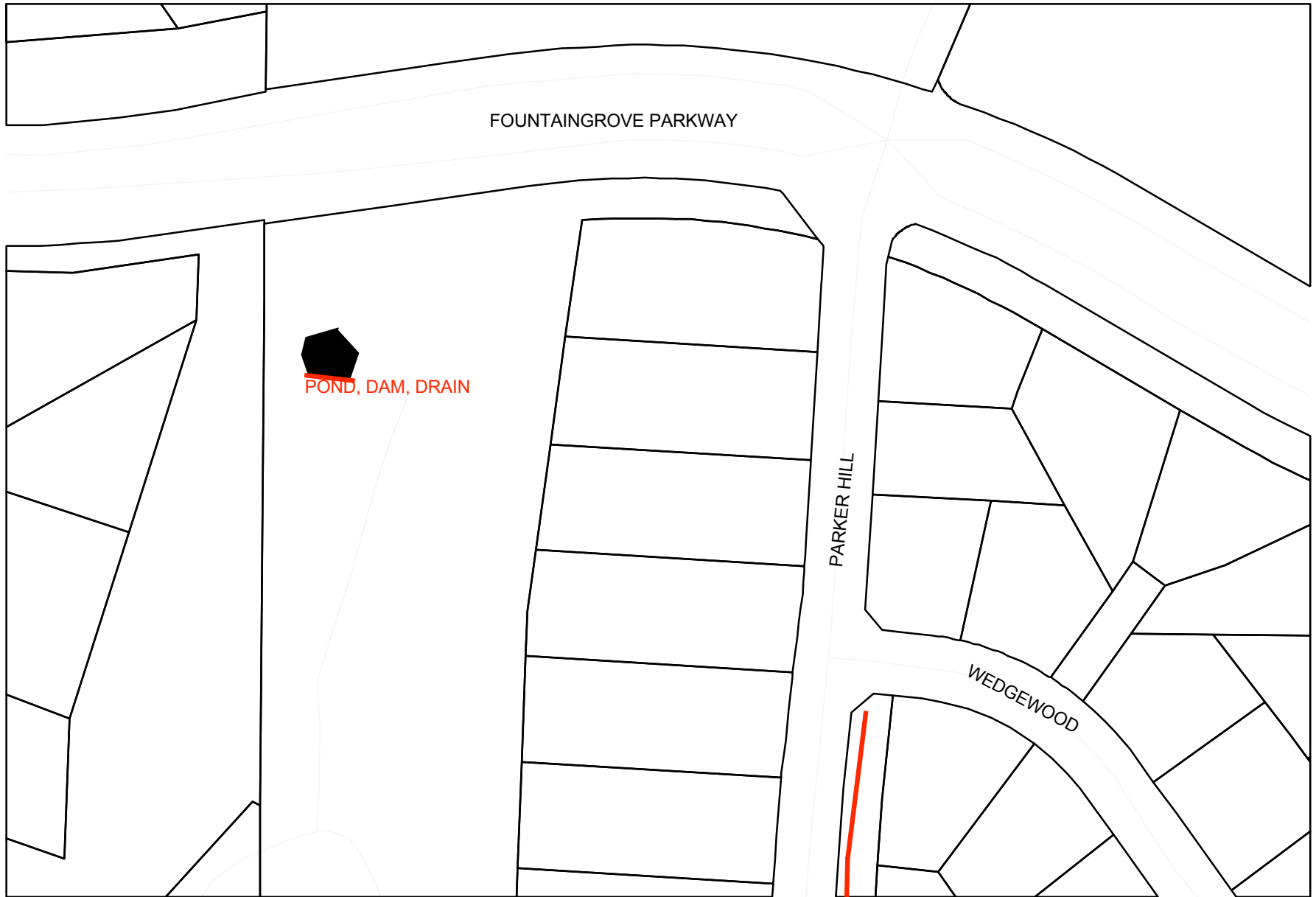

UPPER EAST FOUNTAINGROVE PARKWAY

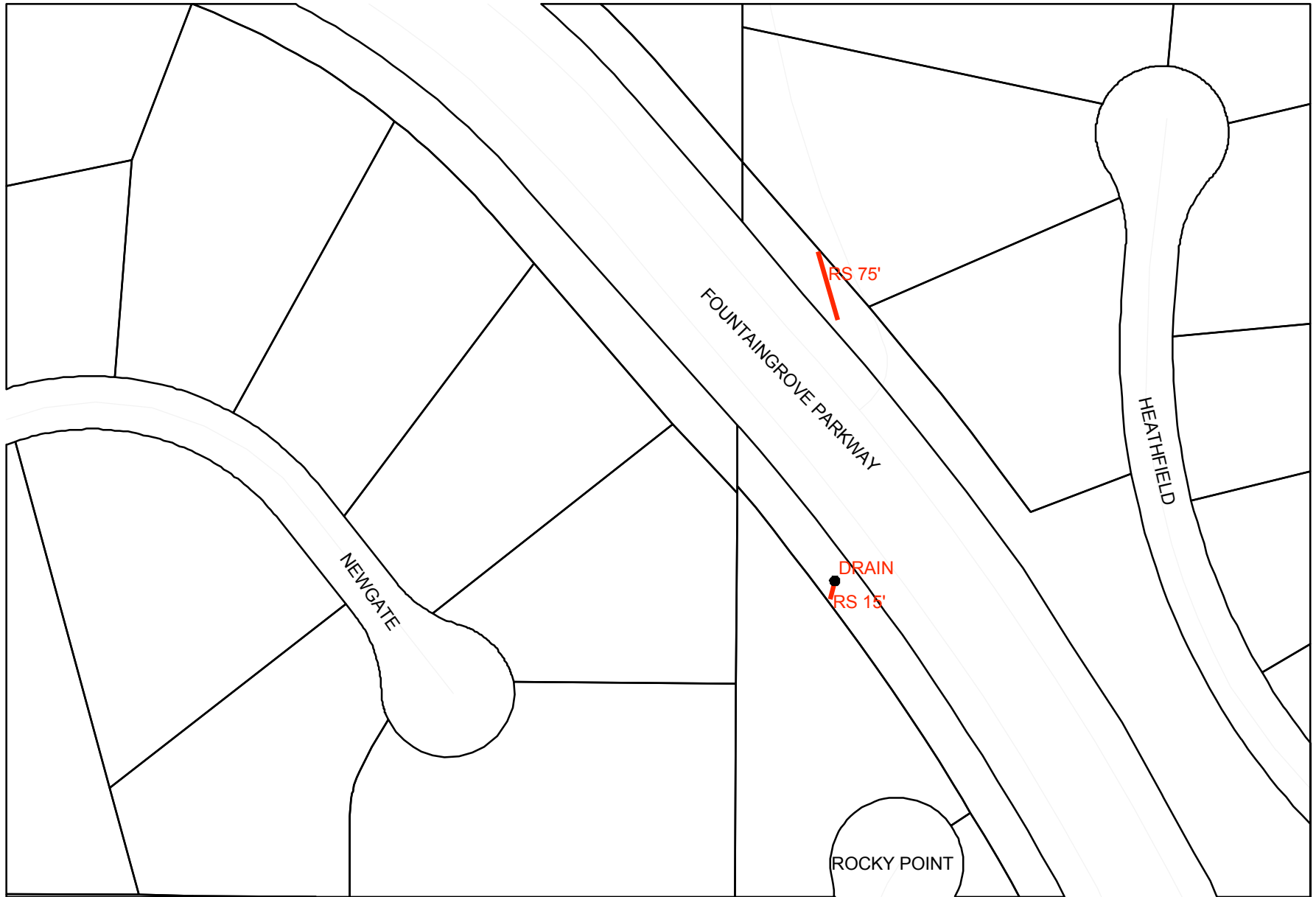

HEATHFIELD, CHANTERELLE, SHELTER GLEN

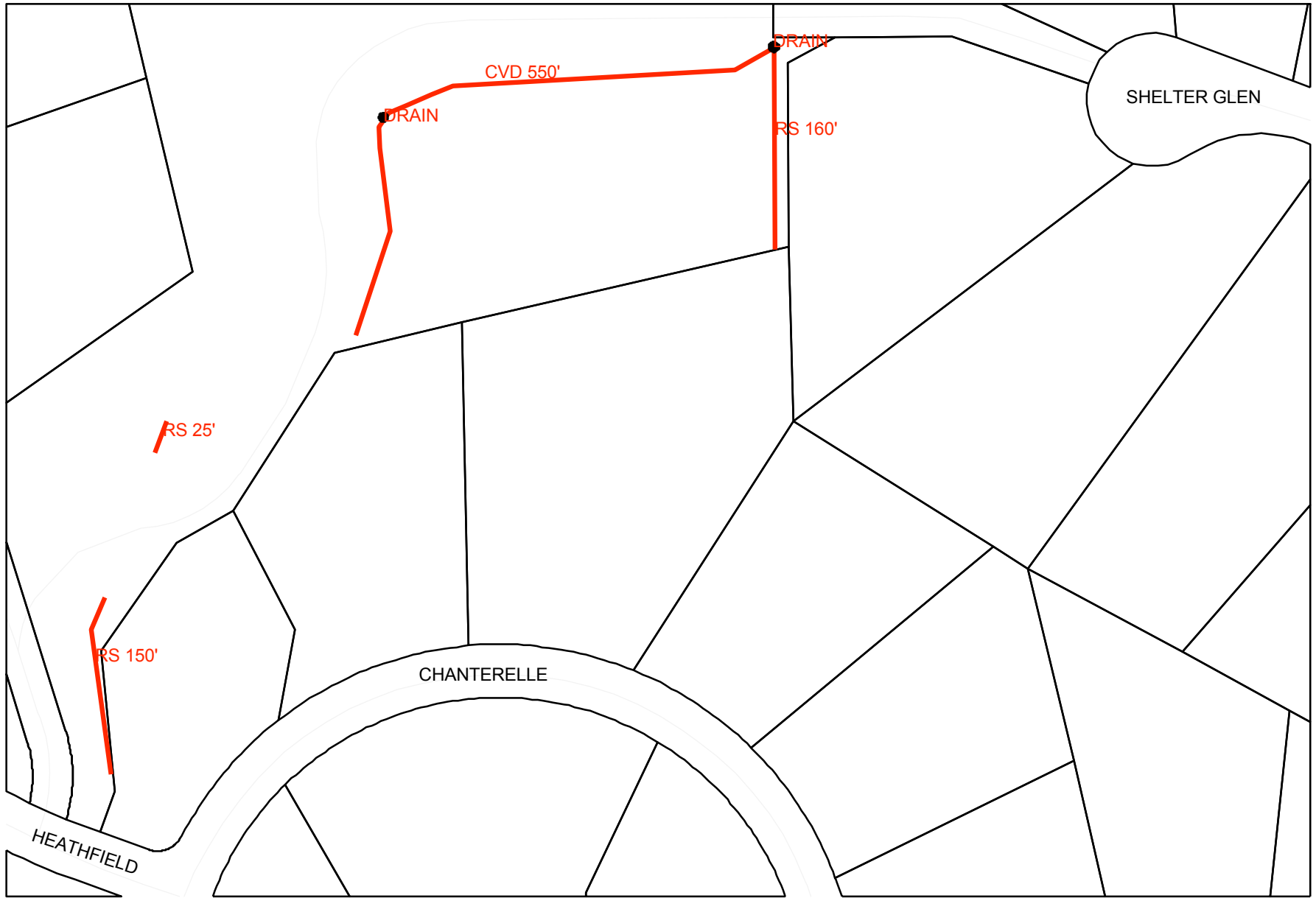

ROCKY POINT, EAST FOUNTAINGROVE PKY

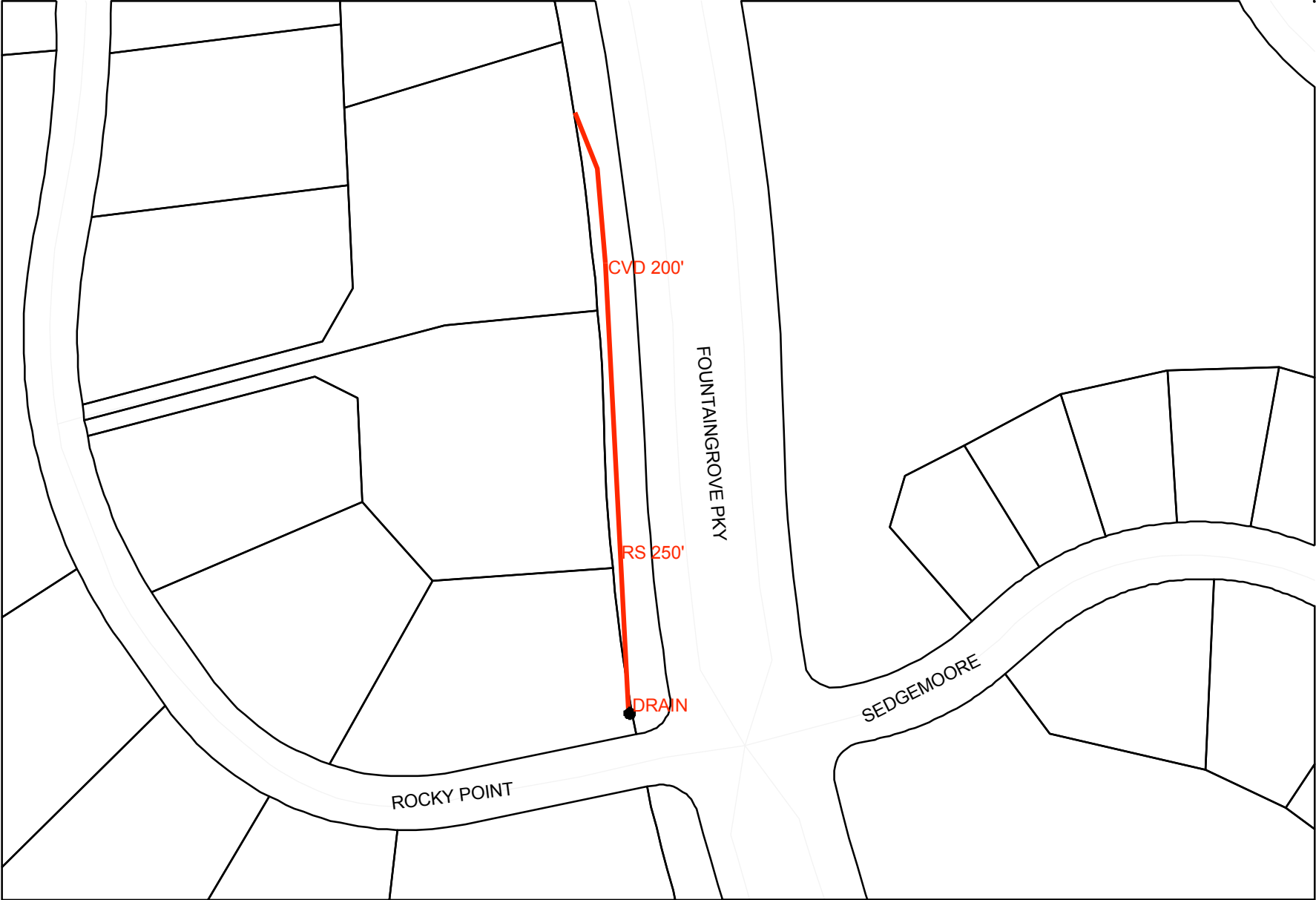

EAST FOUNTAINGROVE PKY BELOW BOULDER POINT

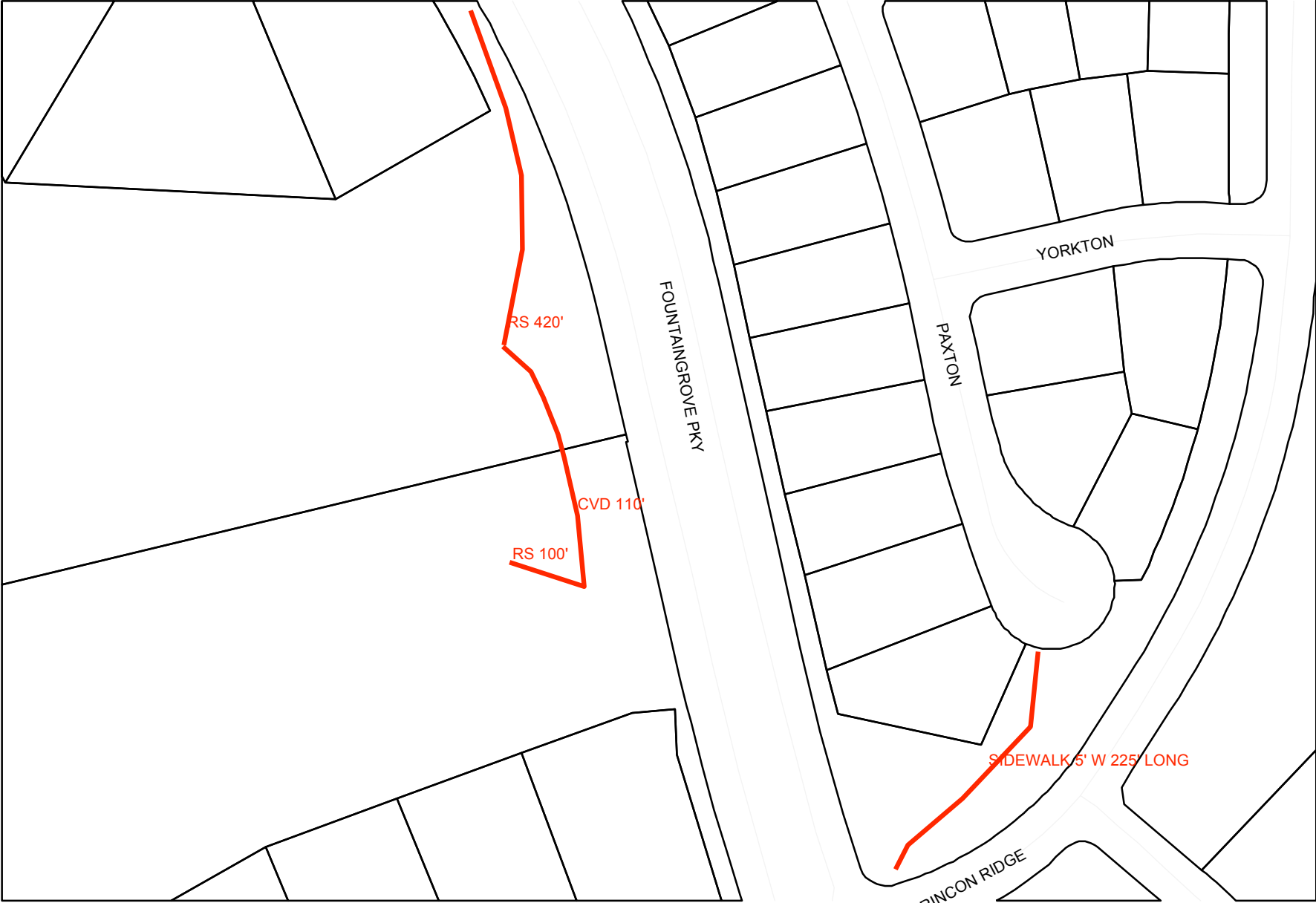

LOWER EAST FOUNTAINGROVE PKY

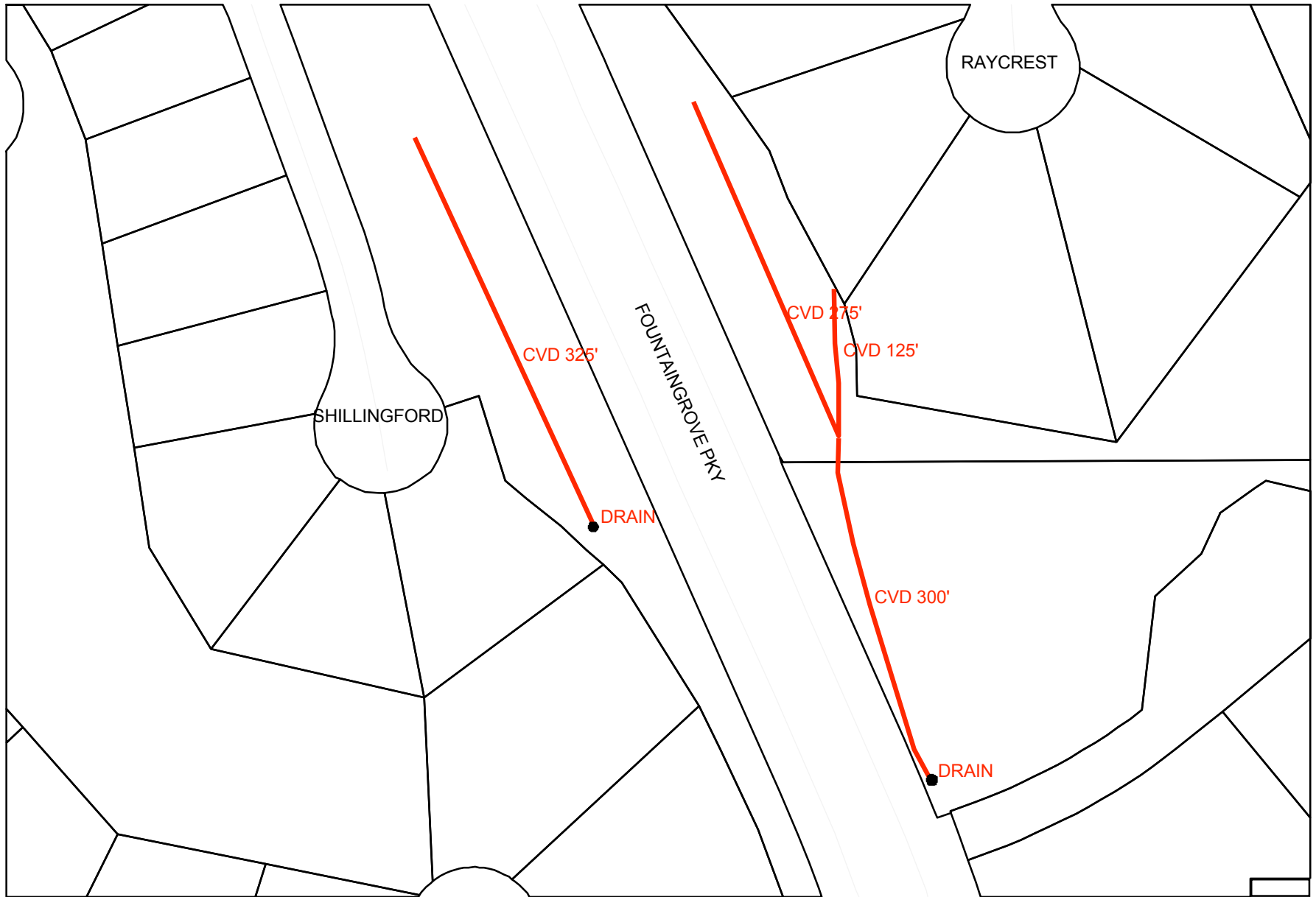

VISTARA INTERIOR

